

MULTIFLEX SYSTEM



The MultiFlex System is designed to offer the self storage developer total control over unit mix configurations and provide the fastest 10x10 grid system to erect. The 10x10 grid allows all interior walls and hallways to be nonstructural. The MultiFlex System is compatible with virtually any exterior surface and finish as well as being erected year round in any climate.

FEATURES & BENEFITS:

- Structural members can be easily fire protected to meet municipal codes for multi story construction.
- Elevated slabs can also meet fire ratings.
- 125 lb storage floor loads for elevated slabs can be achieved with 4" normal weight concrete. Elevated slabs can be pour after building is erected.
- Structures can be designed to meet seismic and high wind regions requirements.
- Allows for interior bracing when using tilt panel exteriors.
- Compatible with membrane and standing seam roof systems.
- Utilizes free standing partitions and hallways.
- Can be erected with local area erectors.
- Allows for greater Flexibility with mechanical equipment, sprinklers and lighting
- Flexible exterior finishes can be integrated to satisfy the most stringent Architectural requirements.

The Most Flexible Storage Building System on the Market Today!

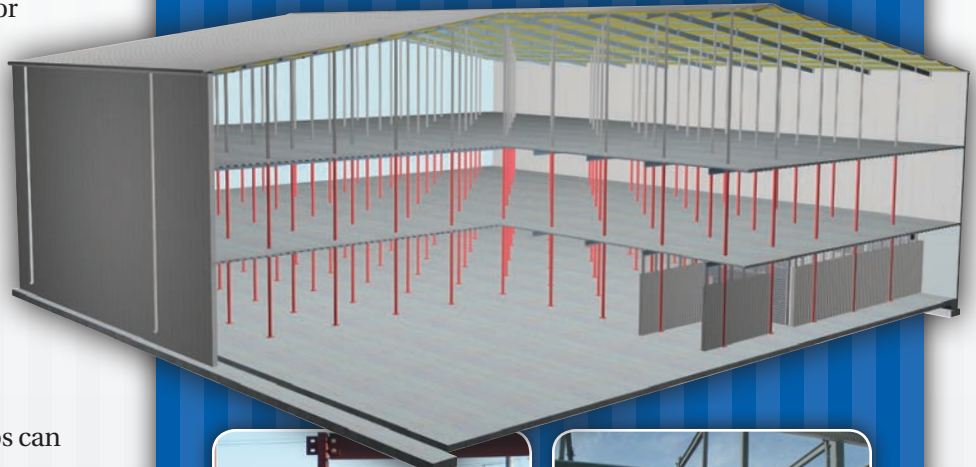

PARAMOUNT
METAL SYSTEMS

800-505-9062

500 Pleasant Valley Drive | Building A | Little Rock, AR 72227

www.paramountmetalsystems.com